

Light Projects ^{LP}

Light Projects Group



LEDStar Interior and Exterior LED Spotlights



LEDStar A versatile interior & exterior spotlight

LEDStar Family Features

- Available in both Spotlight and Recessed fitting formats.
- Interchangeable optics to allow beam angles to be changed on site.
- LEDs can be 90+ CRI for good colour rendering or 80+ CRI for maximum output.
- Available with plug and play IP68 connector for easy on site installation.
- Suitable for 1-10V, Phase and DALI Dimmable Drivers. DMX on request.
- Fully Machined Aluminium Housing.
- LED Lifetime of 50,000hrs L70 (LM-80).
- Five Year Guarantee



Lighting Design: Lighting Design International

LEDStar 1

- Extremely compact range that has great lumen output for its size thanks to the use of the CREE XP-G2 LED.
- PCB Protection to prevent cross polarity and voltage surges.
- Holographic diffusers combined with narrow collimator.
- Sustainable PCB's.

LEDStar 3

- Using 3 x CREE XP-G2 LEDs, this is ideal for colour matching when used within the same scheme as the LEDStar 1.
- Also available in Window Reveal and Wall fitting formats.
- PCB protection to prevent cross polarity and voltage surges.
- Holographic diffusers combined with narrow collimator.
- Sustainable PCB's.

LEDStar 4

- Highest output of the family thanks to the use of the CREE CXA1310 COB LED.
- Single point light source allows for superior beam quality.
- Also available in Window Reveal and Wall fitting formats.
- Interchangeable optics to allow beam angles to be changed on site.
- Sustainable COB.

LEDStar 5

- Best colour rendering and beam quality of the family thanks to the use of Soraa's Light Engines and their breakthrough GaN-on GaN technology.
- Also available in Window Reveal and Wall fitting formats.
- Compatible with Soraa's Snap system which allows you to customise the shape and colour of the beam for each individual fitting on site.
- Supported with TM-30-15 data
- Sustainable Light Engine Module



LEDStar 1 Spotlight

Description: Exterior/Interior LED Spotlight
Part Number: 4500800x-xxx-xx-x (See specification table)
LED Source: 1xCREE XP-G2 LED (2 SDCM Binning)
Weight: 0.15kg

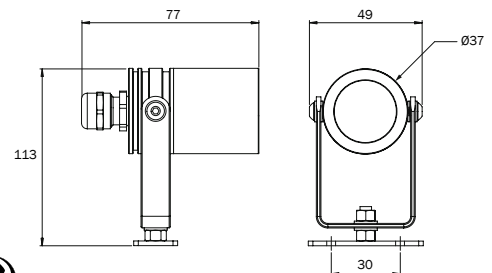

LEDStar 1 Recessed

Description: Exterior/Interior LED Recessed Light
Part Number: 4500810x-xxx-xx-x (See specification table)
LED Source: 1xCREE XP-G2 LED (2 SDCM Binning)
Weight: 0.14kg

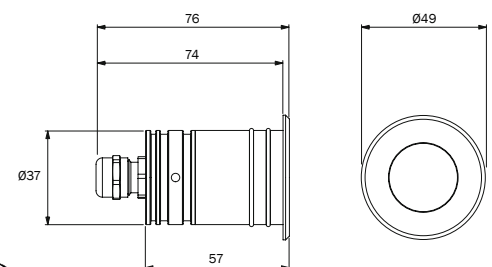



LEDStar 3, 4 & 5 Spotlight

Description: Exterior/Interior LED Spotlight
Part Number: 4503x0xx-xxx-xx-x (See specification table)
LED Source:
 LEDStar 3 - 3 x CREE XP-G2 LED (2 SDCM Binning)
 LEDStar 4 - CREE CXA1310 COB LED (2 SDCM Binning)
 LEDStar 5 - Soraa Light Engine SLE16-06/SLE16-08
Weight: 0.63kg

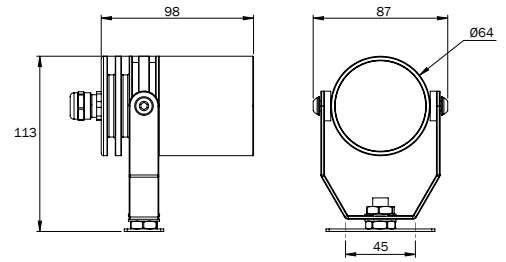

LEDStar 3, 4 & 5 Recessed

Description: Exterior/Interior LED Recessed Light
Part Number: 4503x1xx-xxx-xx-x (See specification table)
LED Source:
 LEDStar 3 - 3 x CREE XP-G2 LED (2 SDCM Binning)
 LEDStar 4 - CREE CXA1310 COB LED (2 SDCM Binning)
 LEDStar 5 - Soraa Light Engine SLE16-06/SLE16-08
Weight: 0.6kg

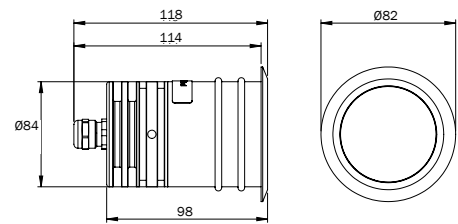

LEDStar 3, 4 & 5 Window Reveal

Description: Exterior/Interior LED Window Reveal
Part Number: 4503x2x0-xxx-xx-x (See specification table)
LED Source:
 LEDStar 3 - 3 x CREE XP-G2 LED (2 SDCM Binning)
 LEDStar 4 - CREE CXA1310 COB LED (2 SDCM Binning)
 LEDStar 5 - Soraa Light Engine SLE16-06/SLE16-08
Weight: 0.6kg

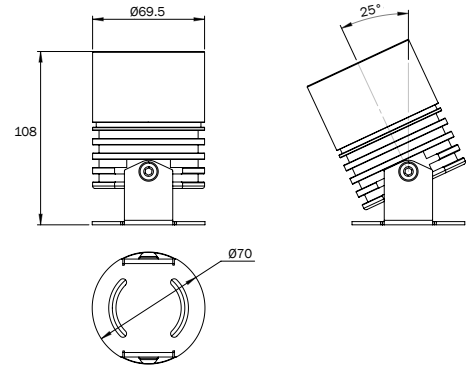

LEDStar 3, 4 & 5 Wall

Description: Exterior/Interior LED Wall Light
Part Number: 4503x3x0-xxx-xx-x (See specification table)
LED Source:
 LEDStar 3 - 3 x CREE XP-G2 LED (2 SDCM Binning)
 LEDStar 4 - CREE CXA1310 COB LED (2 SDCM Binning)
 LEDStar 5 - Soraa Light Engine SLE16-06/SLE16-08
Weight: 0.6kg

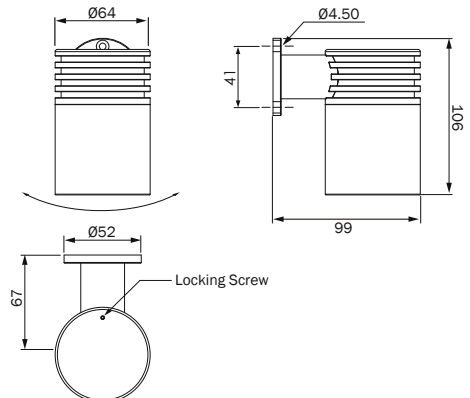

LEDStar Specification Table

SPECIFICATION EXAMPLE: 45035010-927-15-2A

LEDStar 5 Soraa Light Engine SLE-08 Spotlight, Fixed 3m Cable, High CRI, Incandescent White 2700K,
15° Beam Angle, Black Anodised Finish

PRODUCT CODE EXAMPLE: 4503501 0 - 927 - 15 - 2A

FITTING	Max Supply Current (mA)	Max Power (W)	Max Lumens		Typical LED Efficiency (lm/W)		Code
			Low CRI	High CRI	Low CRI	High CRI	
LEDStar 1 Spotlight	1050	3.3	327	220	99	67	4500800
LEDStar 1 Recessed	700	2.1	245	166	117	79	4500810
LEDStar 3 Spotlight	1050	9.9	961	660	97	67	4503300
LEDStar 3 Recessed	700	6.3	735	498	117	79	4503310
LEDStar 3 Window Reveal	1050	9.9	961	660	97	67	4503320
LEDStar 3 Wall	1050	9.9	961	660	97	67	4503330
LEDStar 4 Spotlight	900	16.2	1500	1050	93	65	4503400
LEDStar 4 Recessed	900	16.2	1500	1050	93	65	4503410
LEDStar 4 Window Reveal	900	16.2	1500	1050	93	65	4503420
LEDStar 4 Wall	900	16.2	1500	1050	93	65	4503430
LEDStar 5 SLE-06 Spotlight	300	8.3	605	525	73	63	4503500
LEDStar 5 SLE-06 Recessed	300	8.3	605	525	73	63	4503510
LEDStar 5 SLE-06 Window Reveal	300	8.3	605	525	73	63	4503520
LEDStar 5 SLE-06 Wall	300	8.3	605	525	73	63	4503530
LEDStar 5 SLE-08 Spotlight	500	13.9	1007	950	72	68	4503501
LEDStar 5 SLE-08 Recessed	500	13.9	1007	950	72	68	4503511
LEDStar 5 SLE-08 Window Reveal	500	13.9	1007	950	72	68	4503521
LEDStar 5 SLE-08 Wall	500	13.9	1007	950	72	68	4503531

CABLE TYPE	Fixed Cable	IP68 Connector + Moulded Cable	IP68 Connector + User Wireable Cable
Code	0	1	2

IP68 Connector is only available in Spotlight and Recessed Fittings

LED COLOUR	Fitting	CRI	Incandescent White 2700K	Warm White 3000K	Cool White 4000K
Code	LEDStar 1 & 3	CRI ≥ 80	NA	NA	840
		CRI ≥ 90	927	930	NA
	LEDStar 4	CRI ≥ 80	NA	NA	840
		CRI ≥ 90	927	930	NA
	LEDStar 5	CRI ≥ 80	827	830	NA
		CRI ≥ 90	927	930	940

LEDStar 1 & LEDStar 3 BEAM Angles	10°	30°	80°	20°/20° Tilt	20°/20° Tilt + Half Moon
Code	10	30	80	20T	20TH

LEDStar 4 BEAM Angles	12°	24°	36°	20°/20° Tilt + Half Moon
Code	10	30	80	20TH

LEDStar 5 BEAM Angles	SLE-06		SLE-08		
	10°	20°/20° Tilt + Half Moon	15°	20°/20° Tilt + Half Moon	25° 36°
Code	10	20TH	15	20TH	25 36

20° / 20° Tilt + Half Moon Beam Angle is only available on the LEDStar 1 Recessed, LEDStar 4 Recessed and LEDStar 5 Recessed.

FINISH	PTFE White RAL 9016	PTFE Black RAL 9011	Special RAL/BS	Black Anodised	Hard Anodised	Bronze Anodised	Silver Anodised
Code	1	2	3	2A	5	5C	9

See individual fitting specification sheets for further details

LEDStar Accessories

Mounting Options: M5 to suit LEDStar 1, M10 to suit LEDStar 3, 4 & 5



Half Shield Cowl



Full Shield Cowl



LEDStar 3,4 & 5 Window
Reveal Half Shield Cowl



LEDStar 1 Eyelid Cowl



Mount Tube

	LEDStar 1	LEDStar 3, 4 & 5
Half Tube Cowl	247-1627-f	450132-f
Full Tube Cowl	247-1628-f	450134-f
LEDStar 3, 4 & 5 Window Reveal Half Shield Cowl	N/A	247-0527-f
LEDStar 1 Recessed Eyelid Cowl	247-1696-f	N/A
Recessed Mount Tube	247-1629-5	450122-4



LEDStar 1 Recessed
Mounting Spring



M5 200mm Ground
Spike with Stop



M10 200mm Ground
Spike with Stop

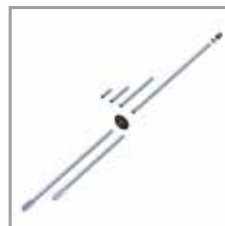

M10 Modular Ground
Spike with Stop



M10 500mm Ground
Spike with No Stop

	LEDStar 1	LEDStar 3, 4 & 5
LEDStar 1 Recessed Mounting Spring	247-1648-4	N/A
M5 200mm Ground Spike with Stop	450024-4	N/A
M10 200mm Ground Spike with Stop	N/A	247-0141-2
M10 Modular Ground Spike with Stop	N/A	31258-0x-xxx-2
M10 500mm Ground Spike with No Stop	N/A	247-0241-2



M5/M10 Sign Mount



M10 Extended Arm



M5 Extended Arm



M5/M10 Edge Clamp



M5/M10 Tree Strap

	LEDStar 1	LEDStar 3, 4 & 5
M5/M10 Tree Strap: LEDStar 3, 4 & 5 Tree Strap Mount	247-1140-2	247-0140-2
M5/M10 Sign Mount: Adjustable sliding wall mounted arm that conceals cable through the arm.....	95090-1f(500)	95090-0f(500)
M5/M10 Extended Arm: Fixed Extended arm mounted to wall. Available in Custom Lengths.....	409907-0f(350)	7160-0f(300)
M5/M10 Edge Clamp: LEDStar 1, 3, 4 & 5 Spotlight, mount with adjustable Clamp to fit over edges....	31267-f	31268-f



LEDStar 1 Half Moon
Front



LEDStar 3 Half Moon
Front

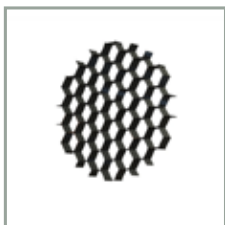

Honeycomb Louvre



Removable User
Wireable IP68 Connector



Removable IP68 Cable
Connector

	LEDStar 1	LEDStar 3, 4 & 5
Removable IP68 Cable Connector: Removable cable assembly with M16 IP68 connector and 3m cable.....	450044-(3)	450044-(3)
Removable User Wireable IP68 Connector: User installable M16 IP68 connector	450045-0	450045-0
Half Moon Front Assembly For LEDStar 1, 4 & 5 Only: 20°/20° Tilt Beam Angle Optic with Half Moon Glass Front assembly. Greatly reduces glare, for example when lighting pathways and stairwells	247-16081-f	247-17081-f

See accessories specification sheets for further details

LEDStar Accessories



LEDStar 1 Optic Diffuser Clip



LEDStar 3 Optic Diffuser Clip



Clip-on Optic for LEDStar 4 Only



Soraa Snap-on's for LEDStar 5 Only

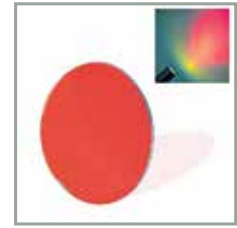

Dichroic Glass Coloured Filter

Spare Optic Diffuser Clip for LEDStar 1 & 3 Only:

Clip with optic diffuser that can be easily interchanged to create various beam angles. Use as replacement for diffuser supplied with fittings. Comes in the following angles:

	LEDStar 1	LEDStar 3, 4 & 5
10° Diffuser	247-1660-10	247-1760-10
30° Diffuser	247-1660-30	247-1760-30
80° Diffuser	247-1660-80	247-1760-80
20°/20° Tilt Diffuser	247-1660-20T	247-1760-20T
Loose Linear Spread Diffuser for Clip.....	247-1666-LS	247-1766-LS
Loose Linear Spread Diffuser for Front of Fitting.....	N/A	247-1761-LS
Linear Spread Diffuser with Clip.....	N/A	247-1760-LS

Spare Clip on Optic for LEDStar 4 Only:

Clip-on optic that can be easily interchanged to create various beam angles. Use as replacement for optics supplied with fittings. Comes in the following angles:

12° Diffuser	N/A	247-1762-12
24° Diffuser	N/A	247-1762-24
38° Diffuser	N/A	247-1762-38

Soraa Snap-on's for LEDStar 5 Only:

Soraa magnetic snap-on accessories can be easily interchanged and stacked on top of each other to create a variety of effects quickly and easily. Use with fittings supplied with 10° or 15° Beam Angles.

Beam Spreader 17°	N/A	206-155
Beam Spreader 25°	N/A	206-120
Beam Spreader 36°	N/A	206-121
Beam Spreader 60°	N/A	206-122
Linear Spreader 10° x 25°	N/A	206-123
Linear Spreader 10° x 36°	N/A	206-124
Linear Spreader 10° x 60°	N/A	206-154
Square Flat Top Spreader 25° x 25°	N/A	206-125
Square Flat Top Spreader 36° x 36°	N/A	206-126
CCT Shifter 1/4 CTO eg. 3000K → 2700K.....	N/A	206-127
CCT Shifter 1/2 CTO eg. 3000K → 2400K.....	N/A	206-128
CCT Shifter 3/4 CTO eg. 3000K → 2200K.....	N/A	206-129
Honeycomb Louvre with 40° cut off angle.....	N/A	206-130
Aim snap - 13° Spread with up to 20° deflection.....	N/A	206-151
Clear Snap - Use with Gel (or similar) for total colour freedom.....	N/A	206-152

Dichroic Glass Coloured Filter : Glasses available to match most LEE filter colour references.

Please enquire	247-1615-###	247-1715-###
----------------------	--------------	--------------



Cable Connector



Flexible Stainless Steel Cable Conduit



Splitter Box



Inground Chamber

	LEDStar 1	LEDStar 3, 4 & 5
Cable Connector	450041-0	450041-0
Flexible Stainless Steel Cable Conduit: To protect cable from harsh exterior environments.....	45008900-A9-##-4	45033004-A9-##-4
Splitter Box:		
94x94x57 - To suit up to 4 outputs.....	42085-10	42085-10
130x94x57 - To suit up to 8 outputs.....	42086-10	42086-10
Inground Chamber		
Round Large - Ø225mm x 250mm.....	177-100	177-100

FINISH	PTFE White RAL 9016	PTFE Black RAL 9011	Special RAL/BS	Black Anodised	Hard Anodised	Bronze Anodised	Silver Anodised
f = Code	1	2	3	2A	5	5C	9

f denotes flexibility of finishes for accessories only

See accessories specification sheets for further details

LEDStar Drivers

1-10V Dimmable

48W 1050mA IP66
(10-100%) LEDStar 1 & 3.....42167-**
33W 900mA IP66
(1-100%) LEDStar 1, 3 & 4.....421783-**
24W 500mA IP66
(1-100%) LEDStar 4 & 5.....421781-**
20W 300mA IP66
(1-100%) LEDStar 5.....42174-300-**

DALI Dimmable

40W 1050mA IP66
(1-100%) LEDStar 1 & 3.....42171-**
33W 900mA IP66
(1-100%) LEDStar 1, 3 & 4.....421632-**
24W 500mA IP66
(1-100%) LEDStar 4 & 5.....421631-**
13W 300mA IP66
(1-100%) LEDStar 5.....421800-300-**

Phase Dimmable

48W 1050mA IP66
(25-100%) LEDStar 1 & 3.....42166-**
36W 700mA IP66
(25-100%) LEDStar 1, 3 & 4.....42140-**
20W 500mA IP66
(25-100%) LEDStar 4 & 5.....421761-**
10W 300mA IP66
(5-100%) LEDStar 5.....421770-**

Non Dimmable

12W 700mA IP66
LEDStar 1 & 3.....42138-**
66W 900mA IP66
LEDStar 4.....421836-900-**
35W 500mA IP66
LEDStar 4 & 5.....421836-500-**

** = 10 (No Driver Box)

20 (1 way)
30 (1-4way)
40 (5-8way)
50 (9-12way)

Further Driver options and individual specification sheets available on request.

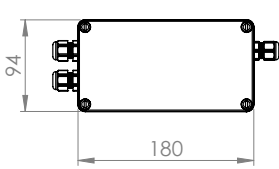

1 Way Driver Box

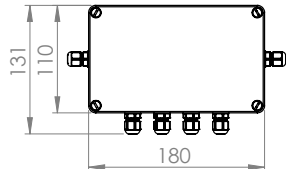

1-4 Way Driver Box

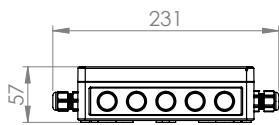

1 Way Driver Box



1 - 4 Way Driver Box



5 - 8 Way Driver Box



9 - 12 Way Driver Box

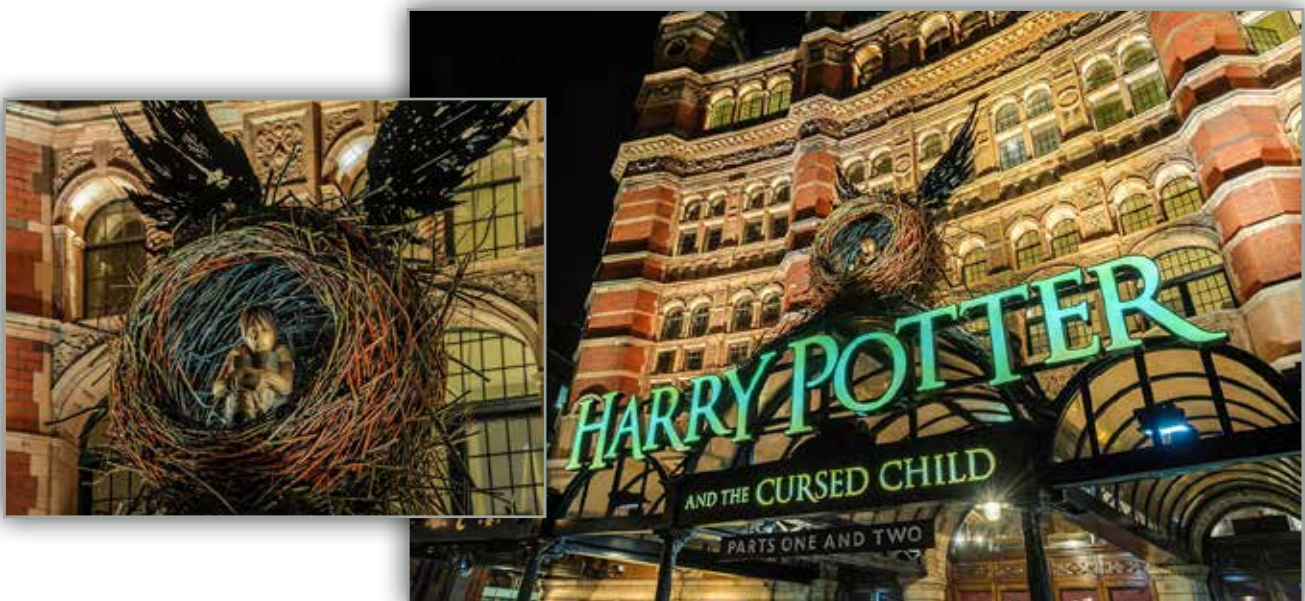

Lighting Design: Richard Godin

Green Line Products

The 'Green Line Products' Collection from the Light Projects Group comprises several ranges of fittings and accessories which have been carefully selected for their high energy efficiency coupled with long life, low maintenance and low life-cycle costs.

Many of the new light sources can save up to 90% energy when compared to traditional incandescent lamps as they use the latest technology available to provide quality light distribution for a fraction of the running cost.

The LEDStar product range is provided with a 5 year guarantee against manufacturing and material defects when installed according to the product specification and used under recommended working conditions. Full details are available on request.

Environmental Policy

The Light Projects Group has a clear intention and commitment to improving its environmental performance with a view to reducing its ecological footprint and impact.

This includes:

- Making effective use of all resources, particularly by embracing the waste and recycling industries wherever possible.
- Maximising the use of recoverable materials.
- Increasing business recycling rates.
- Seeking ways to minimise power and water usage.
- Reducing CO2 emission levels and other polluting factors.
- Using only CE compliant components and, wherever possible, sourcing products from ISO1400:1 accredited companies.
- Promoting ethical and environmental excellence throughout the design, manufacture and supply chain.
- Delivering all materials in the most sustainable manner possible.
- Developing 'future-proof' products wherever possible to allow for compatibility with emerging technologies.

Light Projects Group

LEDStar is just one of the products in the **Light Projects** lighting range from the Light Projects Group.

Visit www.lightprojects.co.uk to find information on further products.

Light Projects specialist interior & exterior range



Scan QR Code
to access website